

## DELPHI DAF

### plugin

142 DELPHI DCMI Daf Truck

946 DELPHI DCMI Hyundai Truck

1622 DELPHI DCMI Nissan Truck

The lay-by pins are placed in the lower side of the ECU.

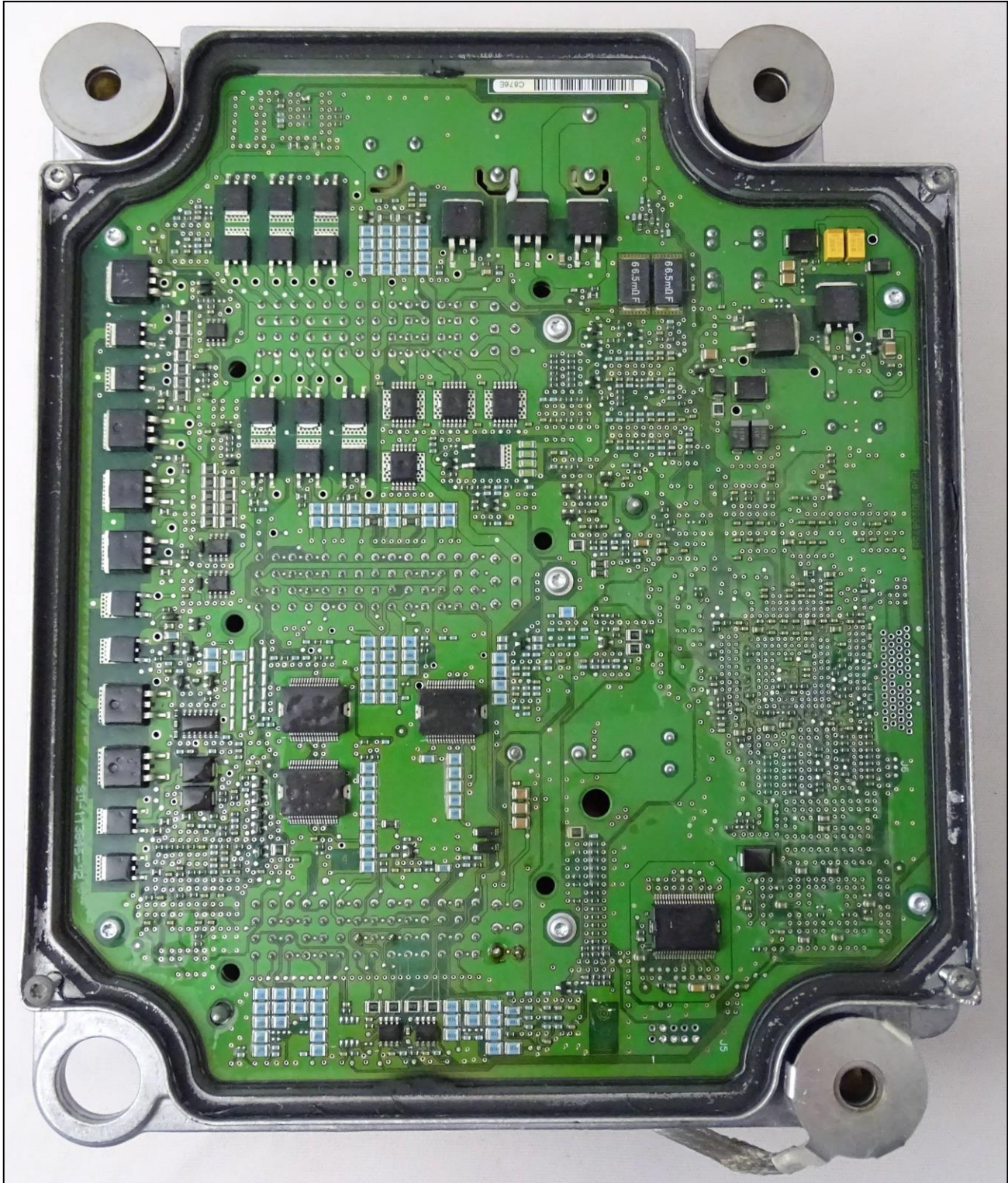

# DELPHI DAF

## ECU CONNECTOR

In order to connect to the ECU use the CABLE F32GN037C/D.  
Make sure that the POWER led (red) on Trasdata is ON.

COLORE FILO WIRE COLOUR	DESCRIZIONE DESCRIPTION
ROSSO RED	POSITIVO DIRETTO POWER BATTERY
ARANCIO ORANGE	POSITIVO SOTTO QUADRO POWER SWITCH ON
NERO BLACK	MASSA GND
GIALLO YELLOW	KLINE
VERDE GREEN	CAN LOW
BIANCO WHITE	CAN HIGH
GRIGIO GREY	POL4 BOOT
BLU BLUE	POL5 CNF1
VIOLA/GRIGIO PURPLE/GREY	TENSIONE PROG. PROG. VOLTAGE
MARRONE BROWN	RESET

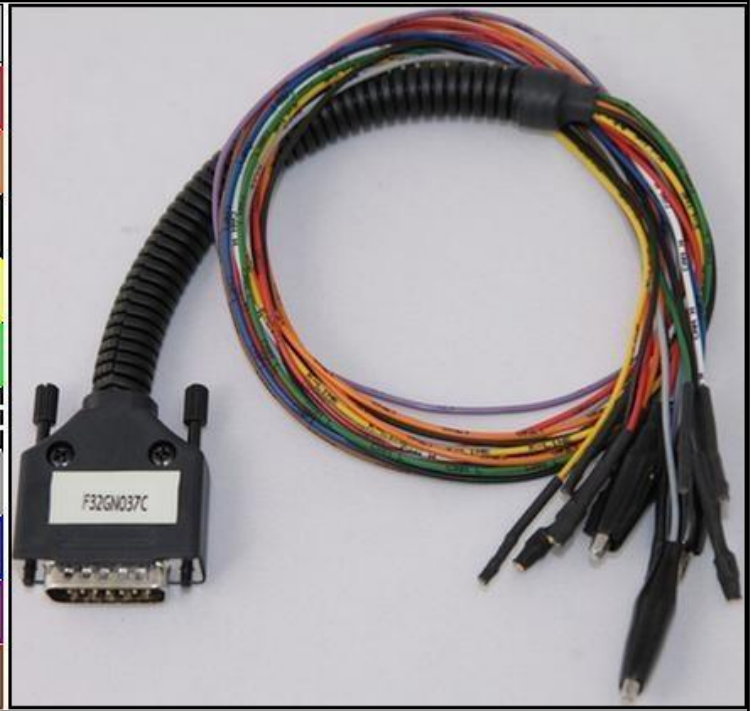

# DELPHI DAF

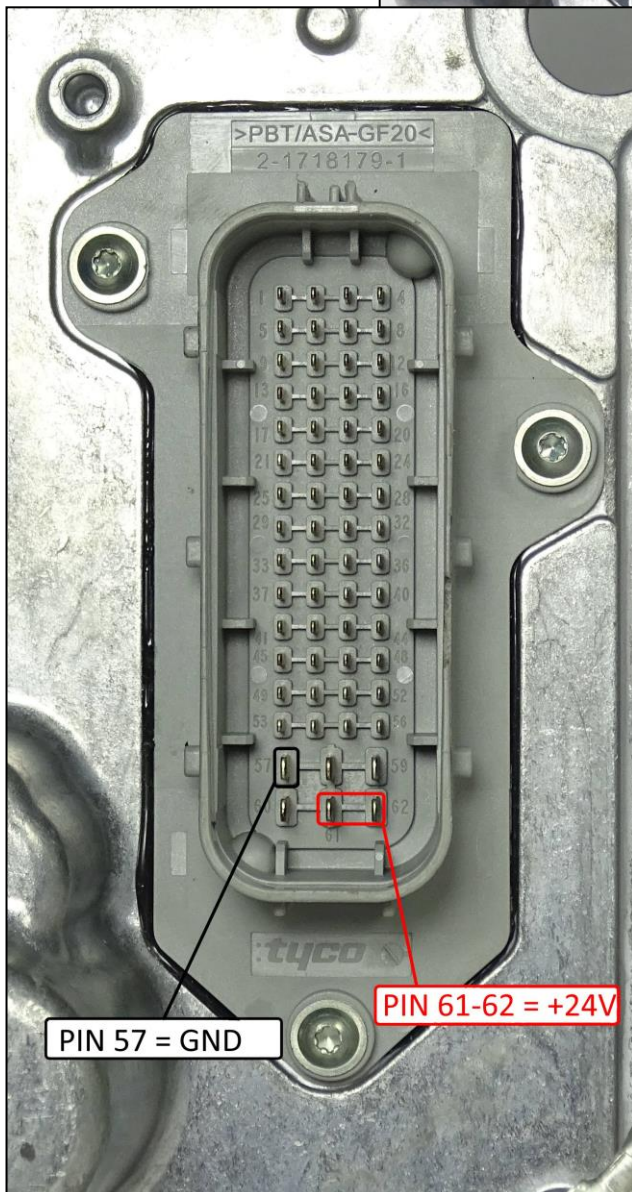
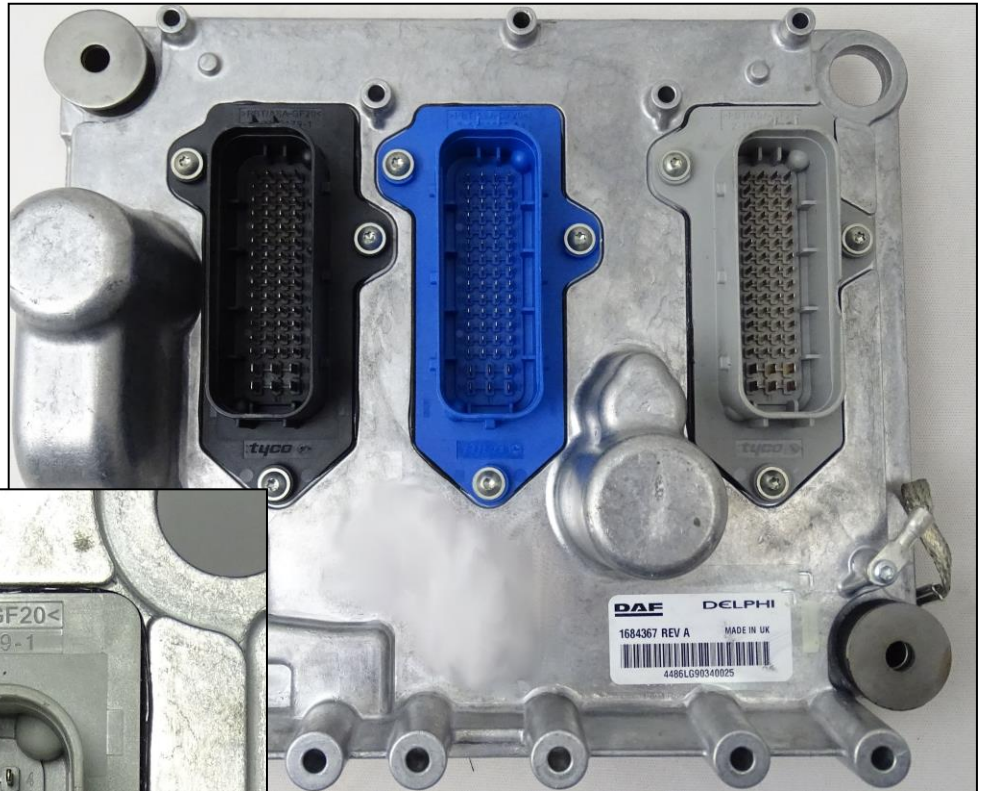

**WARNING:** due to the relevant power absorbed by the ECU at the beginning of the communication it is necessary to feed the ECU with an external power supply or a car battery. Connect the power cable F32GN003 to the New-trasdata and then to the power source. The ECU must be powered through the Trasdata using the F32GN037C/D cable.

To the power feeding pins 61 and 62 (+24V) you can connect both wires red (VECU) and orange (VKEY) of the F32GN037C/D cable, they both have 24V signal.

# DELPHI DAF

## DIRECT CONNECTION

For the direct connection it is required the adapter F34NTA03.

It is necessary to solder the guiding pin strips on the 10 pads shown in the picture, in which you will place the F34NTA03 adapter.

After placing the ECU with the lay-by pins and the adapter on the lower side connect the flat cable F34NTF01, the violet wire of the cable must be on your right.

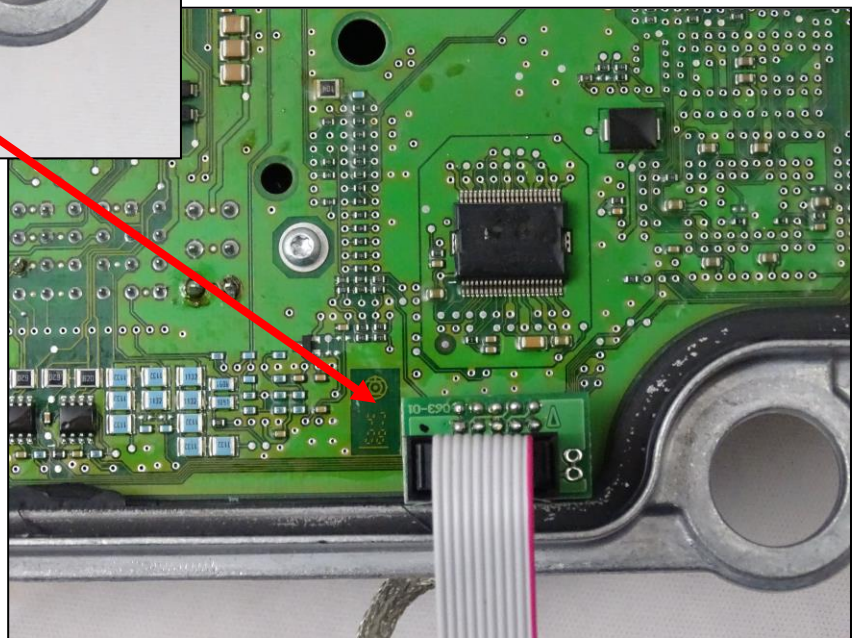
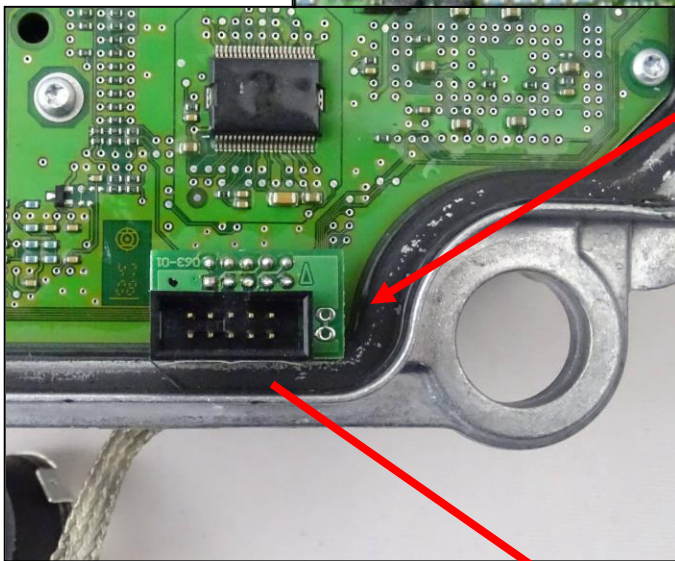
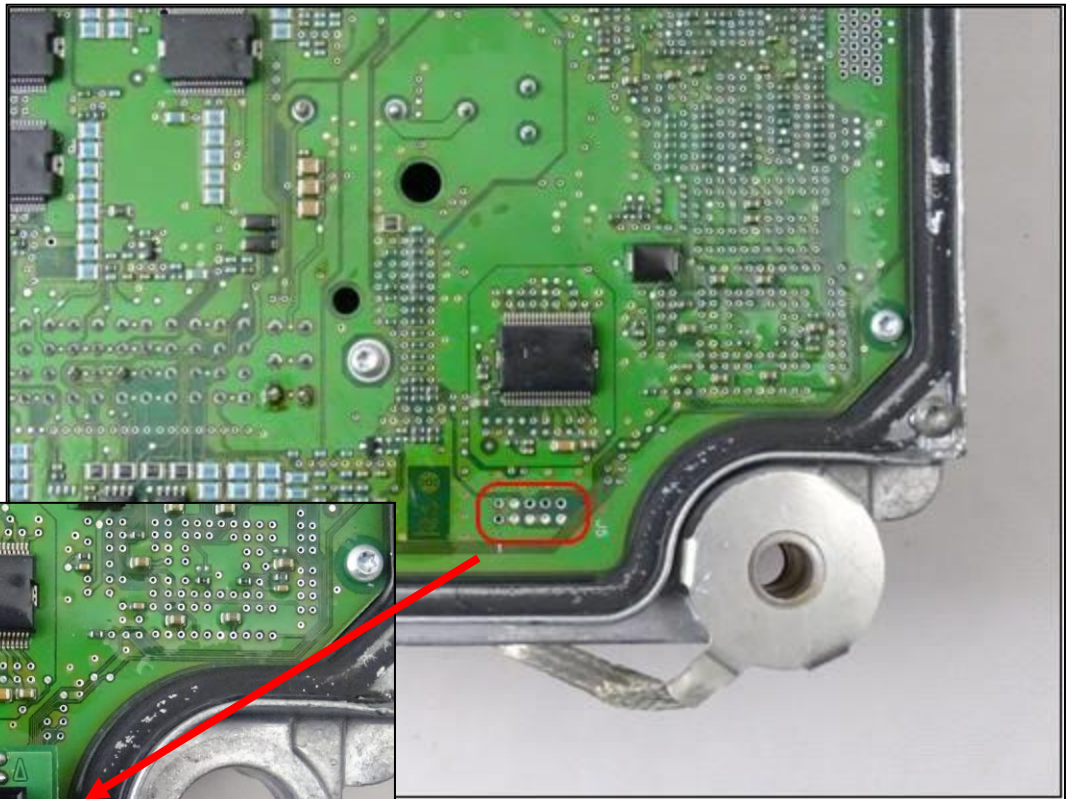

# DELPHI DAF

## METAL POSITIONING FRAME CONNECTION

For the metal positioning frame connection is required the F34DM001 adapter, place the ECU and the adapter as shown in the following picture.

